

PLUMBING LEGEND	
S1	SINKS AND FAUCETS - SEE CABINET DRAWINGS & SCHEDULE BELOW FOR SPECIFICATIONS. CABINET MAKER TO MAKE COUNTER-TOP CUT-OUTS. PLUMBER TO PROVIDE FIXTURES & MAKE FINAL CONNECTIONS AND FURNISH DRAIN OUTLET, PERFORATED GRID STRAINER, TAIL PIECE, P-TRAP, SPEEDWAY STOPS & ALL NECESSARY TUBING.
TI	ACCESSIBLE WATER CLOSET - DURAVIT PRESSURE-ASSISTED, WALL-HUNG, ACCESSIBLE TOILET w/ CONCEALED TANK IN WALL. (1.6 GPF) FURNISH & INSTALL WC UNIT WITH OPEN FRONT SEAT & COVER. SEE ELEVATION B/A1 REGARDING LOCATION.
HW	ELECTRIC HOT WATER HEATER - EXISTING UNIT (VERIFY CONDITION) UNIT LOCATED IN EXISTING MECHANICAL CLOSET IN BASEMENT. PROVIDE INSULATING BLANKET, OVERFLOW PAN/DRAIN & SEISMIC RESTRAINTS AS NECESSARY.
COMP	AIR COMPRESSOR - RUN TYPE 'L' COPPER PIPE AS SHOWN ON PLAN. TERMINATE AT COMPRESSOR WITH 1/2" F.P.A. THERE SHALL BE NO LEAKS DURING A 100 LB./48 HR. TEST BY PLUMBING CONTRACTOR PRIOR TO CLOSING ACCESS TO LINES. PROVIDE 2" FRESH AIR INTAKE PIPE FROM EXTERIOR (VERIFY LOCATION). SEE MFR'S SPECS FOR NEW OR RELOCATED UNIT. (EQUIPMENT N.I.C.)
CV	CENTRAL VACUUM - RUN SCHEDULE 40 PVC AS SHOWN AND SIZED ON PLAN WITH LONG RADIUS FITTINGS (ALL FITTINGS ABOVE 1" TO BE OF DWV TYPE. WHERE DWV FITTINGS ARE NOT AVAILABLE, RIGHT ANGLE TURNS ARE TO BE MADE WITH SLOPED T's, Y's, OR 45'S) PROVIDE 1" IN 20' SLOPE BACK TO UNIT IN BASEMENT. PROVIDE 2" VENT TO THE EXTERIOR. SEE MFR'S SPECS FOR NEW OR RELOCATED UNIT. (EQUIPMENT N.I.C.)
WM	WATER MANIFOLD - INSTALL VALVE (SUPPLIED BY OTHERS) ON CW SUPPLY LINE SERVING ALL COLD WATER CONNECTIONS (EXCEPT VACUUM PUMP & HOT WATER HEATER) THROUGHOUT THE SUITE. VALVE TO BE ACCESSIBLE FOR MANUAL OVERRIDE. SEE MFR'S SPECS FOR ADDITIONAL INFORMATION.
WD	WATER DISTILLATION UNIT - CENTRAL WATER DISTILLATION UNIT (MODEL # T.B.D.) SUPPLIED & INSTALLED BY AQUA-PRIX; HAYWARD, CA; (888) 840-7873 (VERIFY MFR.) PROVIDE OVERFLOW DRAIN & 1/2" PLUMBED WATER LINE TO UNIT. POLY TUBING TO SINKS & DISPENSERS AT SINKS TO BE SUPPLIED & INSTALLED BY AQUA-PRIX AT EACH SPECIFIED SINK. (SPECIFIC SINKS TO BE DETERMINED) UNIT TO BE INSTALLED IN EXISTING MECHANICAL CLOSET IN BASEMENT. (VERIFY LOCATION)
DJB	DENTAL JUNCTION BOX (RECESSED IN FLOOR) - FURNISH 1" VACUUM BRANCH & 1" AIR LINE. JUNCTION BOX TO BE CONSTRUCTED & COVERED BY THE GENERAL CONTRACTOR. (SEE DTL. E/A1) INSTALL 1/2" ANGLE STOP ON AIR & WATER LINE. TO BE LOCATED IN FIELD BY DFH REP.
A/G	AIR AND GAS WALL VALVES - STUB OUT AIR & GAS LINES FROM WALL OR COUNTER AND FINISH WITH M.P.T. INSTALL VALVES SUPPLIED BY EQUIP. SUPPLIER.
MT	MODEL TRIMMER - RUN 1/2" C.W. LINE AND FINISH WITH CHROME PLATED SHUT-OFF VALVE AT 43" A.F.F. (EQUIPMENT N.I.C.)
UC	ULTRASONIC CLEANER - INSTALL DISHWASHER NIPPLE ON SINK DRAIN LINE FOR DRAIN FROM ULTRASONIC CLEANER.
LD	LOOP VENT - INSTALL LOOP VENT TO FIT WITHIN SINK CABINET. SEE DETAIL, THIS SHEET AND COORDINATE WITH CABINET MAKER.

CABINET SINK FIXTURE SCHEDULE			
ROOM #	ROOM NAME	QTY.	SPECIFICATION
5	TOILET ROOM	1	AMERICAN STANDARD #9960.001 "MEZZO" SEMI-COUNTERTOP SINK w/ AMERICAN STANDARD "CERAMIX" S.L. FAUCET #2000.101X
6	TOOTH BRUSHING	2	CORIAN #820 INTEGRAL COUNTER SINK (NOTE: SINK INSTALLED BY CABINET MAKER) w/ CHICAGO #748-335 BUBBLER
8	LAB	1	ELKAY # PSR-1722 STNL. STL. SINK w/ AMERICAN STANDARD "ELITE" S.L. FAUCET & SPRAY #4453
9	STERILIZATION	1	ELKAY # ELU-1418 STNL. STL. SINK (UNDERMOUNT) w/ AMERICAN STANDARD "CERAMIX" S.L. "HI-FLOW" FAUCET & SPRAY #2021.831 w/ GUARDIAN EQUIPMENT DECK-MOUNTED EYE WASH #G5022GSDH-LC
10	BAY OPERATORY (AT CENTRAL ISLAND)	2	CORIAN #820 INTEGRAL COUNTER SINK (NOTE: SINK INSTALLED BY CABINET MAKER) w/ AMERICAN STANDARD "CERAMIX" S.L. FAUCET #2000.101X
10	BAY OPERATORY (AT PENINSULA)	1	CORIAN #820 INTEGRAL COUNTER SINK (NOTE: SINK INSTALLED BY CABINET MAKER) w/ AMERICAN STANDARD "CERAMIX" S.L. FAUCET #2000.101X
12	RECORDS ROOM (AT BACK CABINET)	1	ELKAY # BLGR-1515 STNL. STL. SINK w/ AMERICAN STANDARD "CERAMIX" S.L. FAUCET #2000.101X
12	RECORDS ROOM (AT CORNER CABINET)	1	CORIAN #820 INTEGRAL COUNTER SINK (NOTE: SINK INSTALLED BY CABINET MAKER) w/ AMERICAN STANDARD "CERAMIX" S.L. FAUCET #2000.101X
16	STAFF LOUNGE	1	ELKAY # PSR-1722 STNL. STL. SINK w/ AMERICAN STANDARD "ELITE" S.L. FAUCET & SPRAY #4453 w/ I.S.E. INSINKERATOR "INSTA-HOT" FAUCET #HC-1100
18	TOILET ROOM	1	AMERICAN STANDARD #9960.001 "MEZZO" SEMI-COUNTERTOP SINK w/ AMERICAN STANDARD "CERAMIX" S.L. FAUCET #2000.101X

## GENERAL NOTES

- OBTAIN ALL PERMITS AND PAY ALL FEES FOR THIS PORTION OF THE WORK. FEES NOT TO BE INCLUDED IN CONTRACT PRICE BUT REIMBURSED DIRECTLY BY THE CLIENT. NOTE THAT ANY ADDITIONAL DRAWINGS, DIAGRAMS OR OTHER INFORMATION REQUIRED FOR A PERMIT SHALL BE PROVIDED BY THE PLUMBING SUBCONTRACTOR AND INCLUDED IN THE BID PRICE. IF THE BUILDING DEPARTMENT REQUIRES PROFESSIONALLY ENGINEERED DRAWINGS, THE COST FOR THESE SHALL BE PAID DIRECTLY BY THE CLIENT.
- ALL WORKMANSHIP, MATERIALS AND TESTS SHALL CONFORM TO ALL APPLICABLE RULES CODES, AND ORDINANCES.
- BIDDING CONTRACTORS SHALL VISIT THE SITE AND ACQUAINT THEMSELVES WITH ALL EXISTING CONDITIONS THAT PERTAIN TO THE PLUMBING INSTALLATION.
- WATER LINES ARE TO BE TYPE L COPPER. CLEAR LINES PRIOR TO EQUIP. INSTALLATION. ALL COLD WATER LINES (EXCEPT TO VACUUM PUMP & HOT WATER HEATER) THROUGHOUT THE SUITE ARE TO BE ROUTED THROUGH THE WATER MANIFOLD VALVE, AS INDICATED ON THE LEGEND.
- UNLESS NOTED OTHERWISE ALL PLUMBING LINES ARE TO BE CONCEALED.
- UNLESS NOTED OTHERWISE THE INSTALLATION OF DENTAL EQUIPMENT IS NOT IN THIS CONTRACT.
- PLUMBER IS RESPONSIBLE FOR PROVIDING ALL FIXTURES & FAUCETS, AS WELL AS INSTALLATION & HOOK-UP. IT SHOULD BE NOTED, HOWEVER, THAT FIXTURES GOING INTO CABINETS ARE SPECIFIED ON THE CABINET DRAWINGS. CABINET MAKER TO PROVIDE ALL NECESSARY CUTOUS. COORDINATE WORK WITH CABINET MAKER.
- DOMESTIC WATER SUPPLY SYSTEM TO BE LAID OUT BY PLUMBING CONTRACTOR. THIS DRAWING SHOWS ONLY THE COLD WATER SUPPLY LINES TO THE DENTAL JUNCTION BOXES.
- PLUMBING CONTRACTOR TO RECEIVE A SET OF CABINET DRAWINGS FROM THE GENERAL CONTRACTOR. THESE SHALL BE USED TO ACCURATELY LOCATE ALL PLUMBING FIXTURES & LINES IN THE WALLS & CABINETS. A LIGHT DOTTED LINE (.....) ON THIS DRAWING INDICATES THE EDGE OF A CABINET AND IS INTENDED TO BRING AN AREA OF POTENTIAL CONFLICT TO THE CONTRACTORS' ATTENTION.
- SEE NOTE ON THE TITLE SHEET (TS) RE: PENETRATIONS.
- WHERE DRAIN & SUPPLY LINES ARE EXPOSED UNDER SINKS & LAVATORIES, PROVIDE SHIELDING & INSULATION AS REQUIRED: "LAV-GUARD #102 (WHITE)" FROM TRUEBRO (800) 340-5969
- NOTE THAT NO WATER LINES ARE TO BE PROVIDED TO THE DENTAL JUNCTION BOXES. WATER WILL BE PROVIDED BY PRESSURIZED STERILE WATER BOTTLES, SUPPLIED BY THE DENTAL EQUIPMENT SUPPLIER OR OTHERS

## PLUMBING PLAN

SCALE: 1/4" = 1'-0"

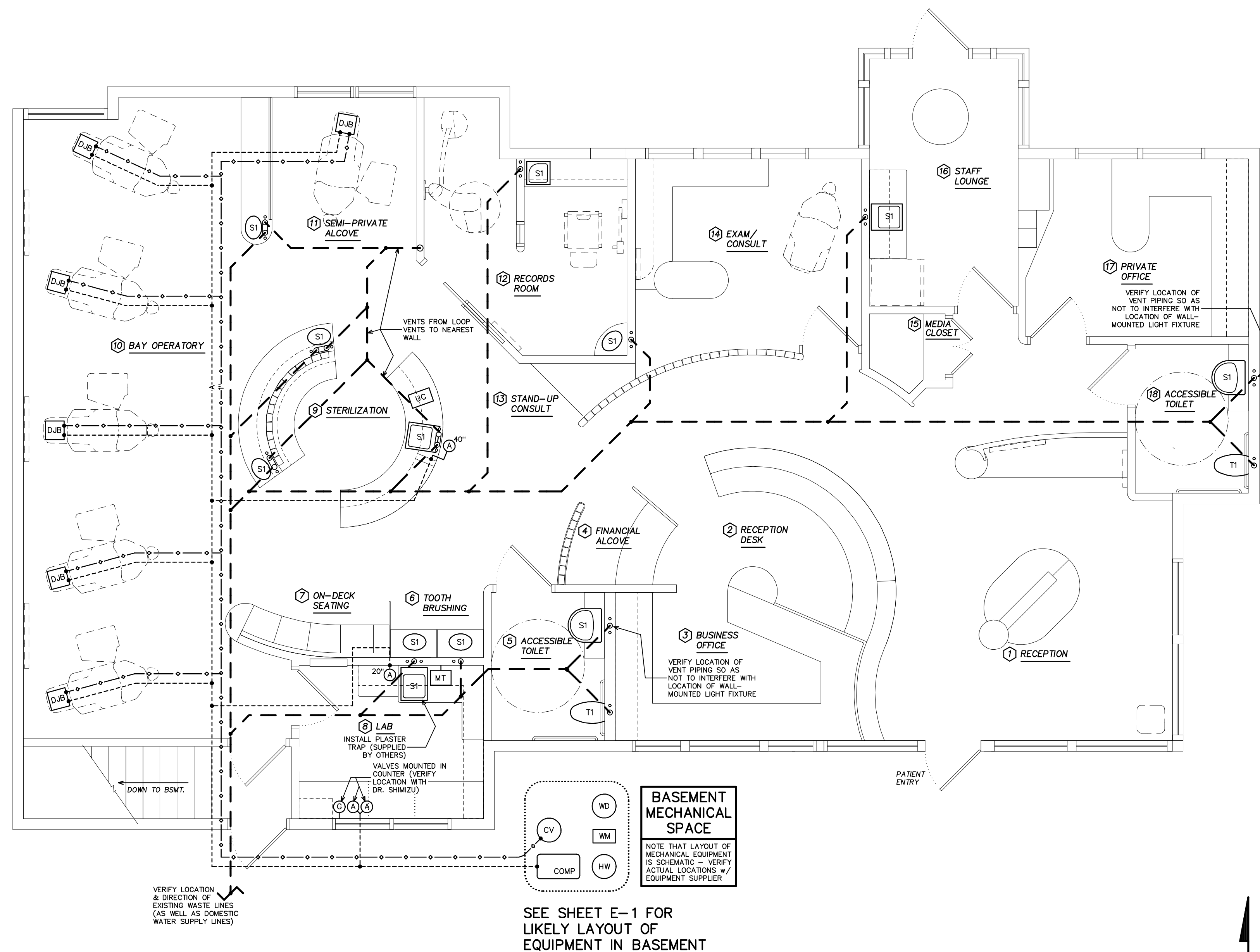

PIPE SCHEDULE	
---	SANITARY WASTE LINE
-(BELOW FLOOR)-	VACUUM BRANCH LINE - SCHEDULE 40 PVC (SIZE AS INDICATED)
-(BELOW FLOOR) (TYPICALLY)	COMPRESSED AIR LINE - 1/2" COPPER

VERIFY WHETHER PLASTIC PIPE IS ALLOWED BY CODE FOR VACUUM OR IF COPPER MUST BE USED

REVISIONS	BY

**DESIGN FOR HEALTH**  
250 DUFOUR STREET, SANTA CRUZ, CA 95060  
PHONE: (831) 425-1869 FAX: (831) 425-3905

AN ORTHODONTIC OFFICE FOR  
**KENNETH A. SHIMIZU, DDS, MSD**  
877 WEST FREMONT AVENUE SUITE G-1 SUNNYVALE, CALIFORNIA 94087

DATE: 20 MAY, 09  
SCALE: AS NOTED  
DRAWN: MBG/RMH  
PROJECT: 20812  
SHEET:

P1